

TECHNICAL DATA BROCHURE

ZTR 312

IMPORTANT - READ OPERATOR'S MANUAL BEFORE OPERATING OR MAKING ADJUSTMENTS SEAT

ADJUSTMENT

Loosen bolts on sliding brackets under each side of the seat, slide seat forward or backward to desired position, tighten bolts. Do not operate the mower with bracket bolts in "loose" position.

MOWER BLADE OPERATION

To engage mower blades, turn engagement lever on floor slowly to the "ON" position. To disengage mower blades, turn lever slowly to the "OFF" position.

REMOVING THE BODY

1. The 312 has a (2) piece polyethylene body. The upper body can be folded forward to expose the transaxle. In some cases, it may be necessary to remove the upper body to service the transaxle.
2. To remove upper body, fold forward and remove bolt (P/N 3088) from cable (P/N 3780). Shut upper body and remove two bolts (P/N 3093) from the front of upper body hinge located on the brake shaft (P/N 9283). Disconnect seat switch (P/N 4047) at plug-in.
3. Reverse above procedure to reinstall.

REMOVING THE MOWER DECK

1. Loosen belt keeper (P/N 7026 & 7027) located under the engine, by loosening two rear engine mounting bolts, allowing the deck drive belt to come free of the rear pulley.
2. Disconnect the wiring loom at the deck safety switch (P/N 4242).
3. Remove the two clevis pins (P/N 3072) from the two rear L-rods (P/N 1355) and slide from slots.
4. Remove clevis pin (P/N 3072) from L-rod attached to lift handle and slide from slot.
5. Remove clevis pin (P/N 3072) from front deck hanger shaft (P/N 1322), located at front of mower deck on slide plates welded at battery box, and remove.
6. Lift front of mower chassis clear of deck. Roll chassis free of the deck.
7. To install, reverse the above procedure.

ADJUSTMENT OF MOWER DECK DRIVE BELT

1. This mower deck drive belt is tensioned by a spring loaded engagement idler quadrant.
2. This system is designed to maintain the proper belt tension at all times.
3. Belt tension can be adjusted by moving the engaging rod (P/N 7013) into the outside hole of engagement handle (P/N 7020).
4. After belt tension is adjusted, check to assure that the mower blade will not turn freely when the engaging rod is in the "OFF" position.
5. If the mower blade turns freely, adjust the blade brake by loosening nut (P/N 3205) at the end of the brake linkage (P/N 7015).
6. After adjustment is achieved, perform the safety checks listed below

IMPORTANT - PERFORM SAFETY CHECKS AFTER MAKING ANY REPAIRS OR ADJUSTMENTS

1. After reassembly, while seated on mower, attempt to start engine with mower deck engaged. Engine should not start. If engine does start, return the mower to an Authorized Dixon Dealer for adjustment or repair.
2. Disengage mower deck and start engine. With the operator in the normal seated position, engage mower deck and remove weight from seat. The engine should stop. If the engine doesn't stop when operator rises from the seat, return the mower to an Authorized Dixon Dealer for adjustment or repair.
3. Engage, then disengage, mower blade in each cutting height. Insure that blade disengages and comes to a stop within (5) seconds in each height position. If blade does not disengage properly, contact your Authorized Dixon Dealer.

PARKING BRAKE ADJUSTMENT

Remove the body as describe above. Tighten nut on brake rod (P/N 2533) located in front of the transaxle on each side, just enough to prevent brake from slipping when engaged.

CAUTION: Over tightening may cause premature wear on the brake band (P/N 5085).

REMOVING THE MOWER BLADE

Secure blade (P/N 2483) from turning. Remove blade bolt from center of blade (P/N 3268), lock washer (P/N 3065) and blade washer (P/N 6113) then remove blade (P/N 2483). To reinstall, reverse above procedure. WARNING: Sharp edges on blade can cause injury! Caution should be exercised when service is required on blade.

(P/N 8114)



DIXON INDUSTRIES, INC
A BLOUNT COMPANY
AIRPORT INDUSTRIAL PARK
PO BOX 1569
COFFEYVILLE KS 67337
0945
316 251 2000
FAX 316 251 4117

BLOUNT

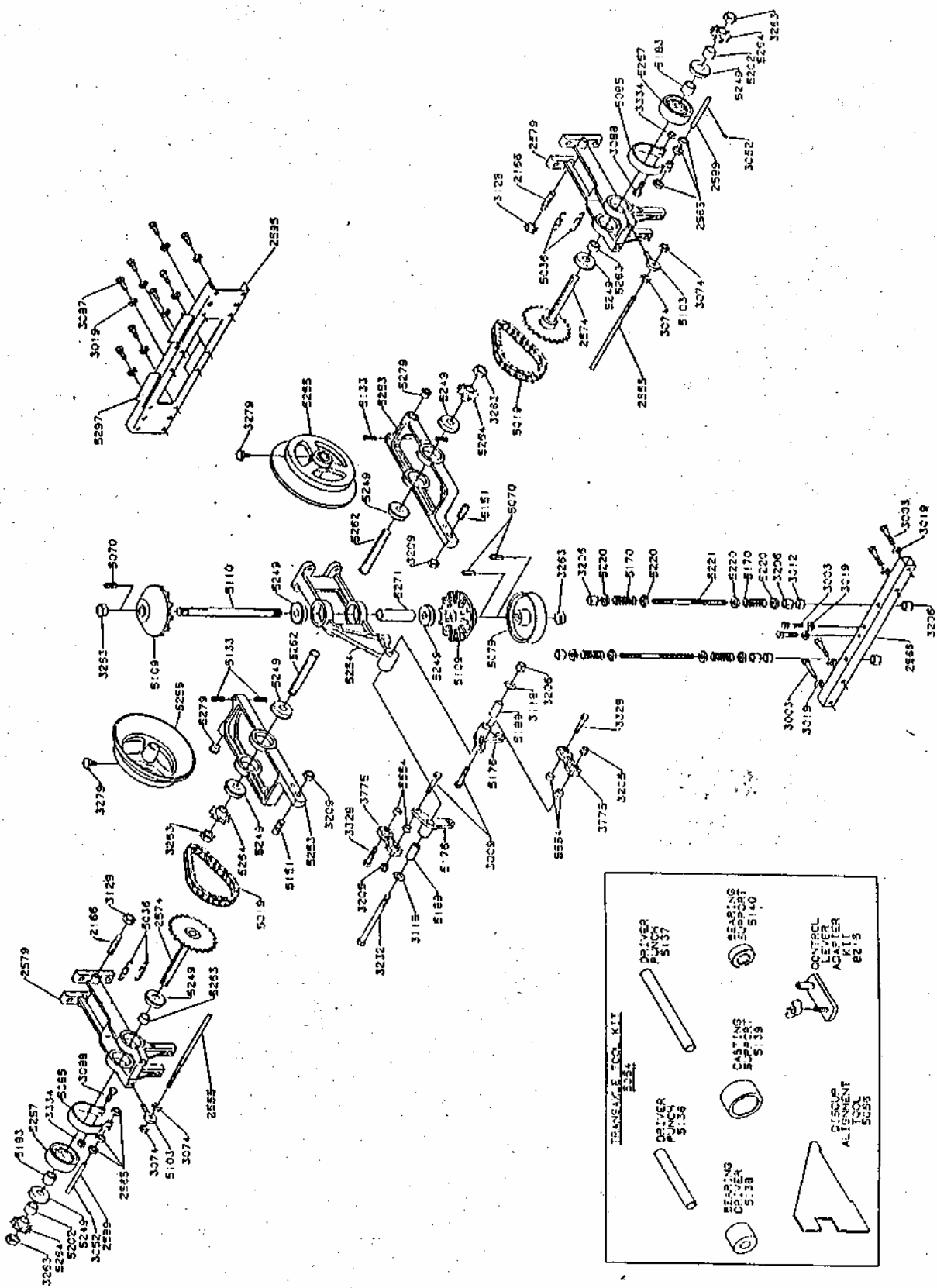

TRANSAXLE ASSEMBLY (MODELS 304, 312, & 361)

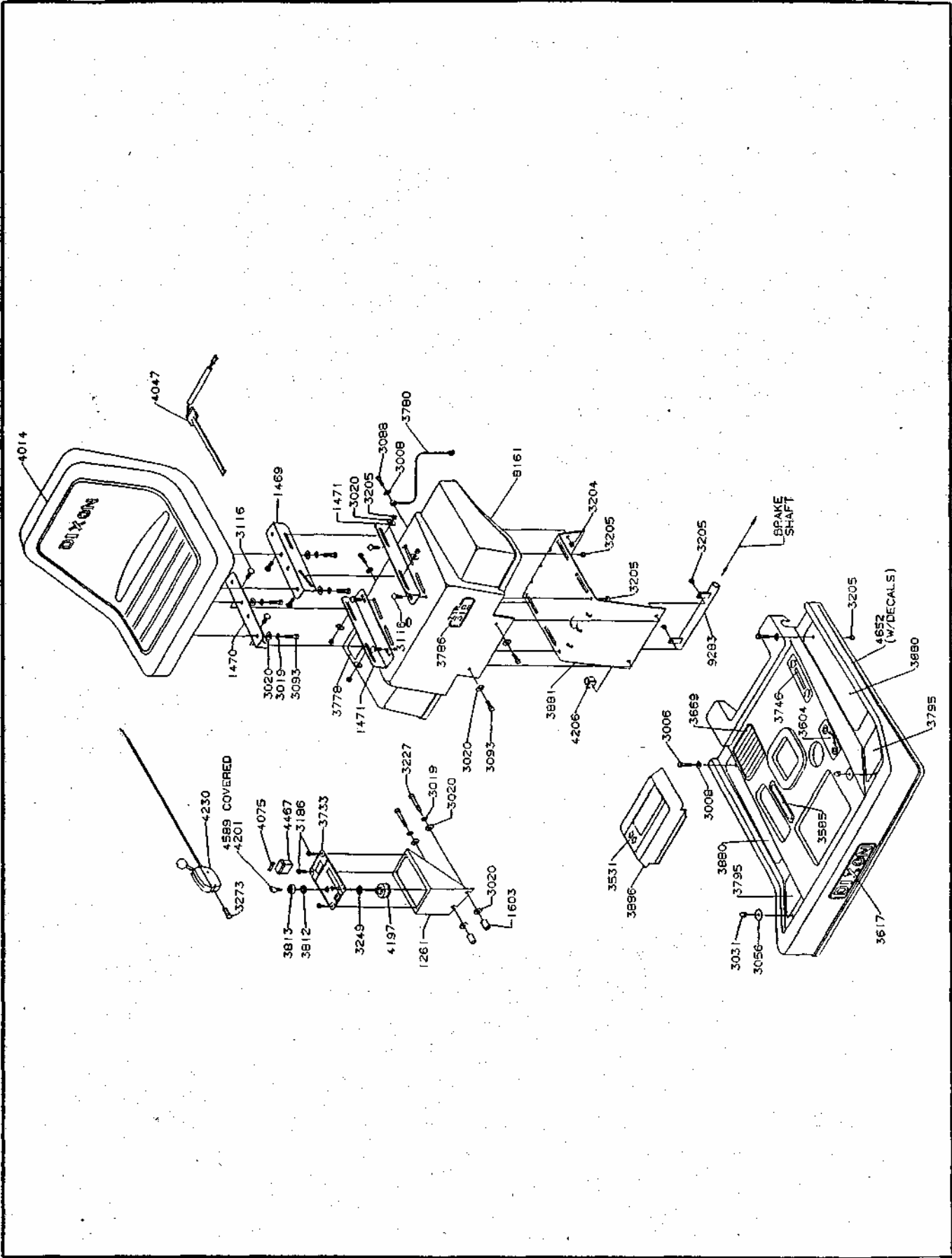

BODY ASSEMBLY (MODEL 312)

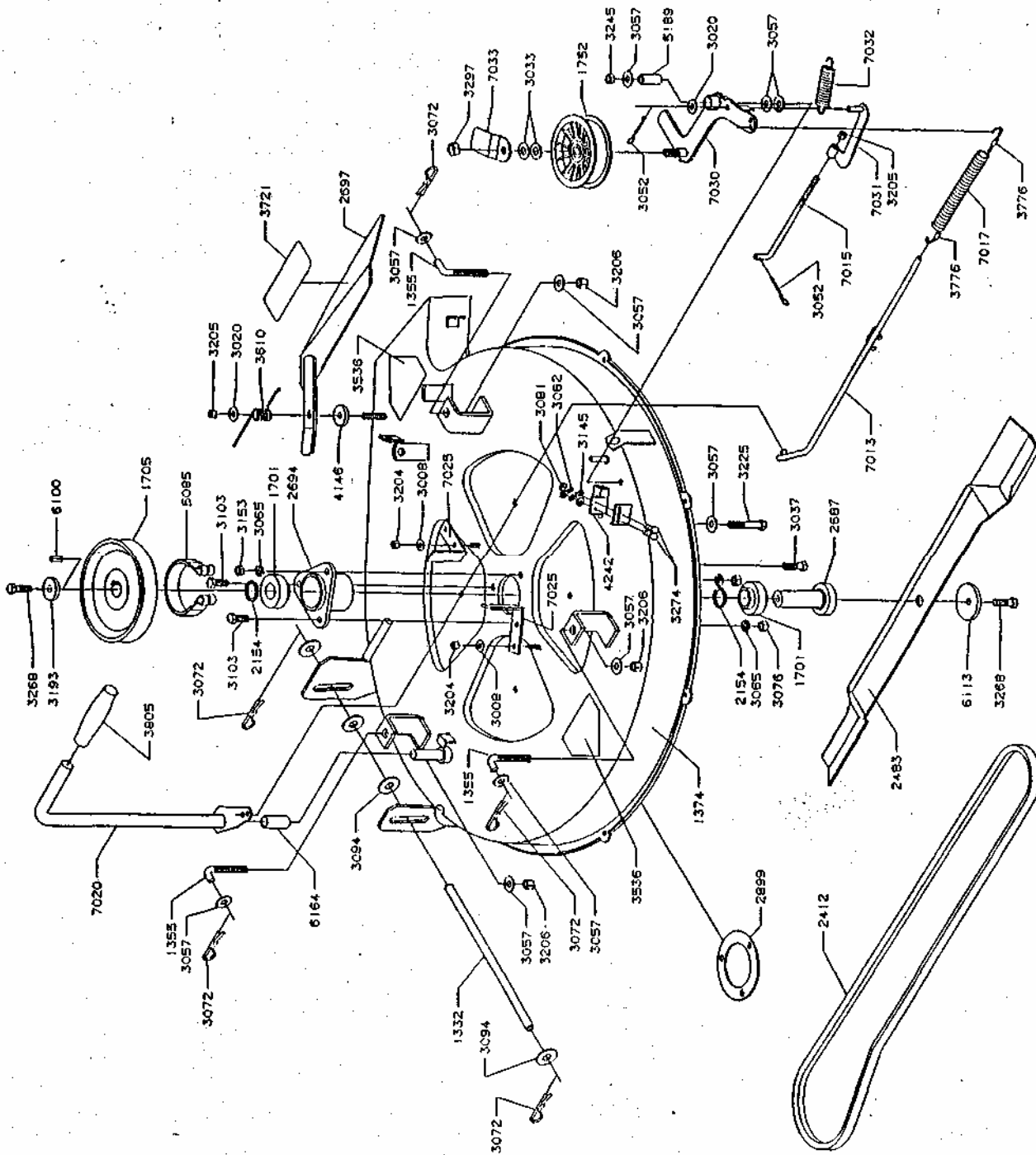

DECK ASSEMBLY (MODELS 304 & 312)

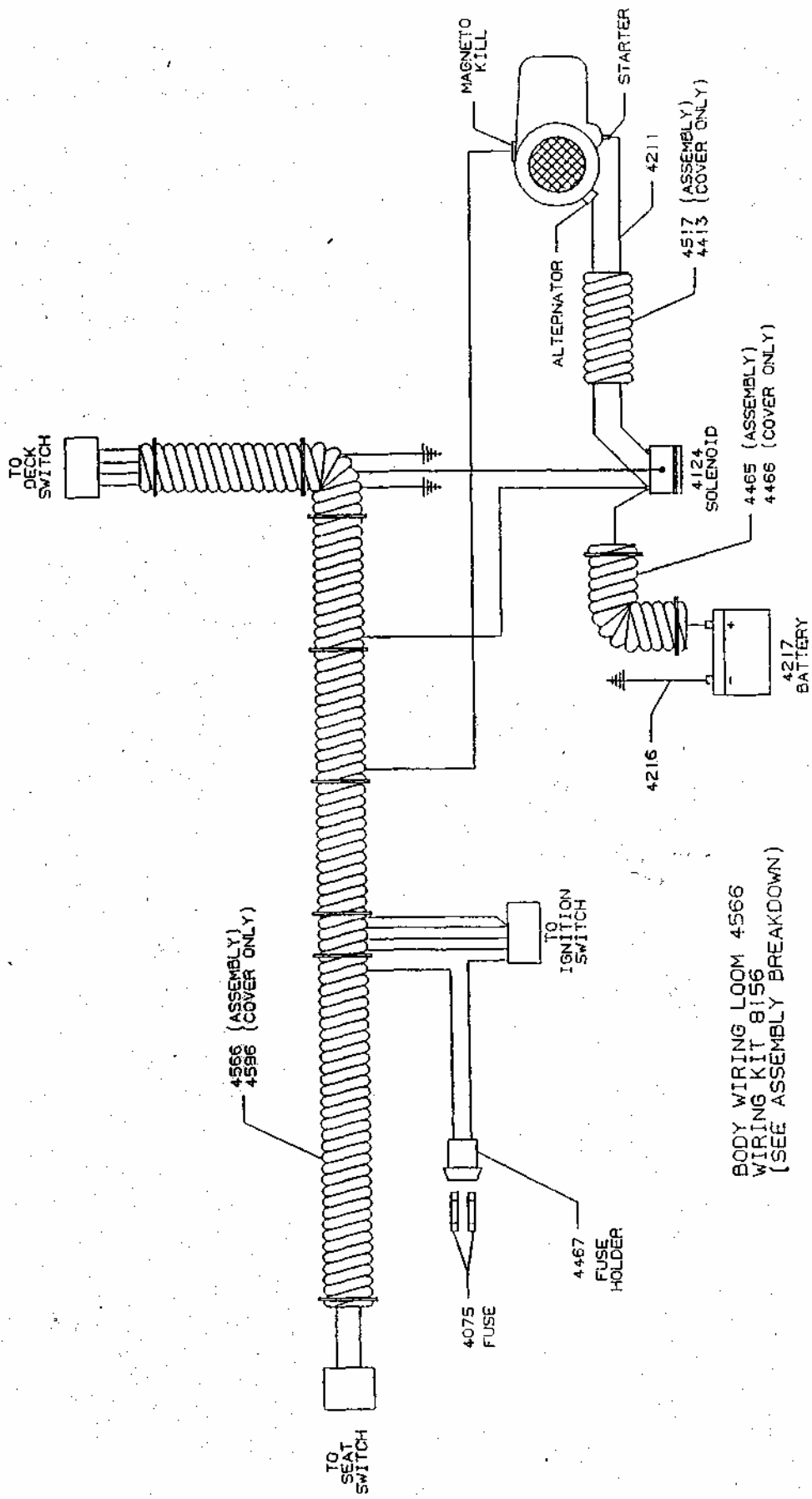

BODY WIRING LOOM 4566
 WIRING KIT 8156
 (SEE ASSEMBLY BREAKDOWN)

WIRING ASSEMBLY (MODELS 304 & 312)