

TECHNICAL DATA BROCHURE

9/89 (Revised)
Page 1

(MODEL ZTR 361)

IMPORTANT - READ OPERATOR'S MANUAL BEFORE OPERATING OR MAKING ADJUSTMENTS

SEAT ADJUSTMENT

Loosen bolts on sliding brackets under each side of the seat, slide seat forward or backward to desired position, tighten bolts. Do not operate the mower with bracket bolts in "loose" position.

MOWER BLADE OPERATION

1. To start mower blades, pull up slightly on blade drive switch handle and move it forward to the "ON" position.
2. To stop mower blades, move switch handle to the "OFF" position.

BODY REMOVAL

1. Disconnect throttle cable from engine.
2. Disconnect wiring loom from the body by turning threaded collar on the connector in a counterclockwise direction. This connector is located at the left rear of the body.
3. Remove four control lever bolts and remove upper control levers (P/N 9079 & 9080).
4. Remove the two acorn nuts on the body floor and release latches on the rear of body near each side.
5. Place height adjustment lever in the vertical position. Carefully lift body from chassis.
6. For assembly, reverse above procedure.

SAFETY CHECKS - IMPORTANT

1. After reassembly of body onto chassis and while seated on the mower, attempt to start engine with mower deck engaged. The engine should not start. If the engine does start, return mower to an Authorized Dixon Dealer for adjustment or repair.
2. Disengage mower deck and start engine with the operator in a normal seated position on the mower. Engage mower deck and remove weight from the seat. The engine should stop. If the engine continues to run when the operator rises from seat, return mower to an Authorized Dixon Dealer for adjustment or repair.

PARKING BRAKE ADJUSTMENT

1. Remove body as described above.
2. Tighten nut on brake rod (P/N 2533), located in front of the transaxle on each side, just enough to prevent brake from slipping when engaged.

CAUTION: Over tightening may cause premature wear on the brake band (P/N 5085).

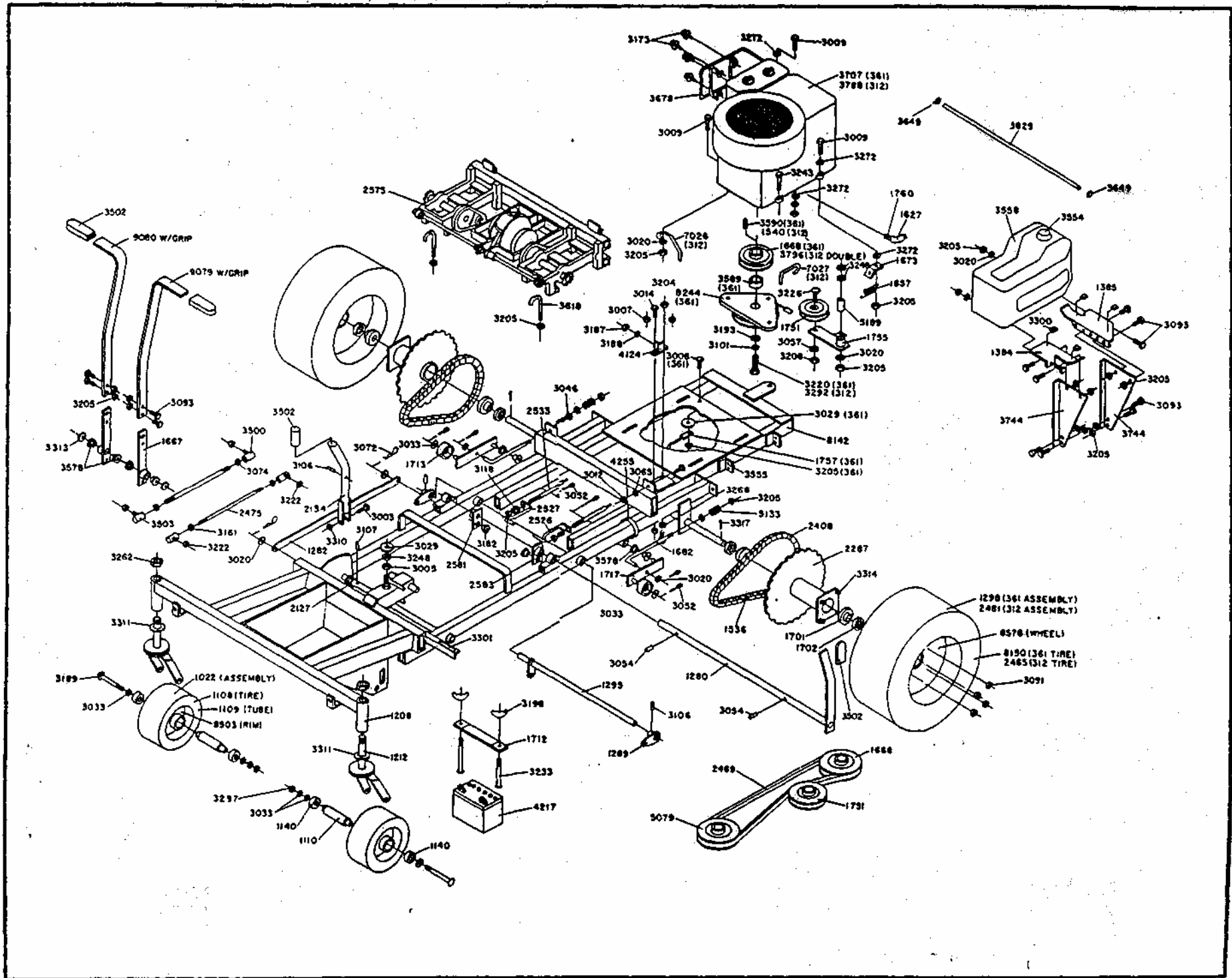

CHASSIS ASSEMBLY (MODEL ZTR 361)

