

(AV) A3/A33

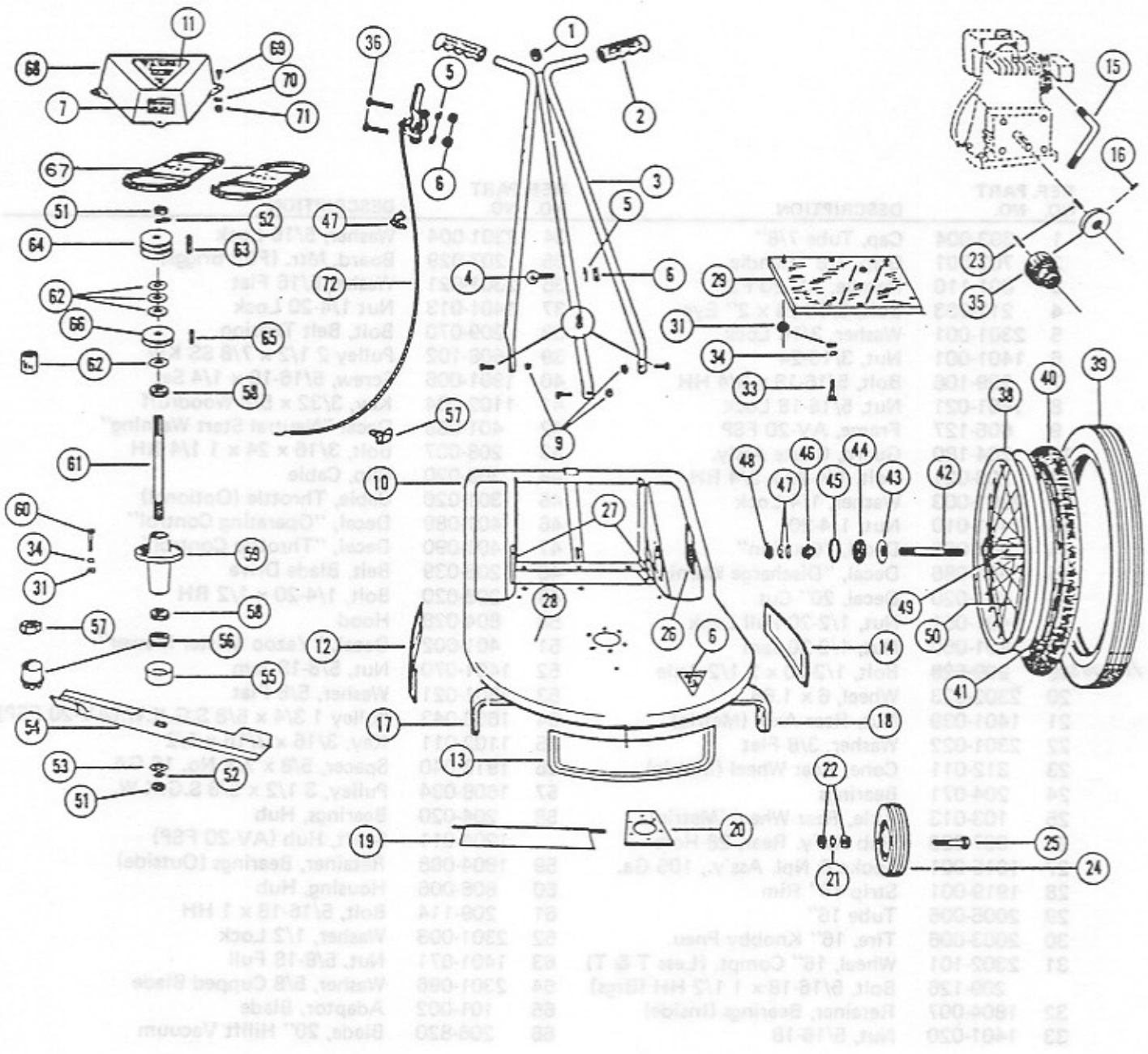

A3/A33

REF. PART NO. NO.	DESCRIPTION	REF. PART NO. NO.	DESCRIPTION
1	303-004 Cap, Tube 7/8"	1901-031	Screw, Set 3/8-16 x 2 Mtr. Adj.
2	703-001 Grip, Handle 7/8"	38 2302-101	Wheel Ass'y., 16" Spoked
3	801-124 Handle Ass'y. (Push Models)	39 2003-006	Tire, 16" Pneu. Knobby Tread
	801-125 Handle Ass'y. (FSP Modles)	2003-001	Tire, 16" Zero Press Straight (Push)
4	212-003 Bolt, 3/16-24 x 2 Eye	2003-026	Tire, 16" Zero Press Cog Tread (FSP)
5	2301-001 Washer, 3/16 Lock	40 2005-005	Tube, 16" Regular
6	401-023 Decal, 22" Comm./Ind.	41 1919-001	Strip, Rim 16"
7	401-005 Decal, "Caution"	42 103-013	Axle, Rear Wheel (Metric)
8	209-108 Bolt, 5/16-18 x 3/4 Hdl. Mtng.	43 1804-007	Retainer, Bearing Inside
	All Modles (3)	44 204-071	Bearing
	209-101 Bolt, 5/16-18 x 1 Hdl. Mtg.	45 1804-008	Retainer, Bearing Outside
	FSP Modles (2)	46 312-011	Cone, Rear Axle (Metric)
9	1401-021 Nut, 5/16-18 Lock	47 309-020	Clip, Cable to 7/8" Tubing
10	605-200 Frame (A3)	48 1401-039	Nut, Rear Axle (Metric)
11	401-002 Decal, "Yazoo Master Mower"	49 807-020	Hub Ass'y. Comp., R. Wheel
12	704-061 Guard, Rt. Side (Weld)	50 1915-001	Spoke & Nipple No. 105 Ga.
13	704-062 Guard, Front (Weld)	51 1401-070	Nut, 5/8-18 Jam (Top)
14	704-063 Guard, Left Sd. (Weld)	1401-071	Nut, 5/8-18 Full (Bot. only)
15	503-004 Ext. Muffler (Clinton Eng.)	52 2301-010	Washer, 5/8 Lock
16	1901-006 Screw Set, Allen Hd. 5/16-18 x 1/4	53 2301-096	Washer, 5/8 Cupped Blade Lock
17	214-008 Bracket, Rt. Front Wheel	54 206-222	Blade, 22"
18	214-009 Bracket, Lt. Front Wheel	55 1906-000	Shield, Dust 21 Series
19	704-114 Guard, Bottom Rear	56 101-002	Adaptor, 21 Series
20	1605-005 Plate, Hub 6-Hole	57 307-004	Clamp, Throttle to Engine
21	2301-008 Washer, 1/2 Lock	58 204-019	Bearing, Hub
22	1401-050 Nut, 1/2-20 Jam (2)	59 806-003	Housing, Hub 6-Hole
23	1102-001 Key, 3/16 x 3/16 x 1	60 209-126	Bolt, 5/16-18 x 1 1/2 HHCS
24	2302-023 Wheel, Front 6 x 1.66 x 1/2 BB	61 1904-025	Shaft, Blade
25	209-529 Bolt, Fr. Axle 1/2-20 x 2 1/2	62 1913-040	Spacer
26	309-002 Clip, Rear Wheel	1913-062	Spacer, 5/8 ID x 1" Push Mdle.
27	601-012 Fenders (Set)	63 1102-001	Key, 3/16 x 3/16 x 1
28	1911-232 Skirt	64 1608-061	Pulley, 3 1/2 x 5/8 DG w/K way
29	207-036 Board Motor (Clinton)	65 1102-011	Key, 3/16 x 3/16 x 1/2 FSP Mdl.
30	211-002 Bolt, 5/16-18 x 1 1/4 Carriage	66 1608-043	Pulley, 1 3/4 x 5/8 SG w/K way
31	1401-020 Nut, 5/16-18	67 205-041	Belt, Blade Drive
32	2301-021 Washer, 5/16 Flat	205-040	Belt, Blade Dr. Bobby Base Eng.
33	209-120 Bolt, 5/16-18 x 1 1/4 HHCS	68 804-021	Hood
34	2301-004 Washer, 5/16 Lock	69 208-020	Bolt, Hood 1/4-20 x 1/2
35	1608-083 Pulley, Eng. D.G. 2 1/2 x 3/4	208-021	Bolt, Hood 1/4-20 x 3/4
	310-001 Clutch, Contrifugal	70 2301-003	Washer, 1/4 Lock
36	208-007 Bolt, 3/16-24 x 1 1/4	71 1401-010	Nut, 1/4-20
37	212-013 Bolt, 1/4-20 x 4 Eye	72 301-024	Cable, Throttle Control
		35 310-001	Clutch (OPTIONAL)

103-102